



1, Pear Tree Cottage,  
Hereford HR2 8NH

£850 Per Calendar Month

TO LET





PROPERTY SUMMARY

A semi-detached stone cottage situated in a rural location adjacent to a chicken farm. The property comprises kitchen with electric oven and hob, lounge with woodburning stove, two bedroom, bathroom, LPG gas central heating and double glazing. There is a garden to the side, patio area and parking for 2 vehicles to the front.

NOTES & COMMENTS

DIRECTIONS

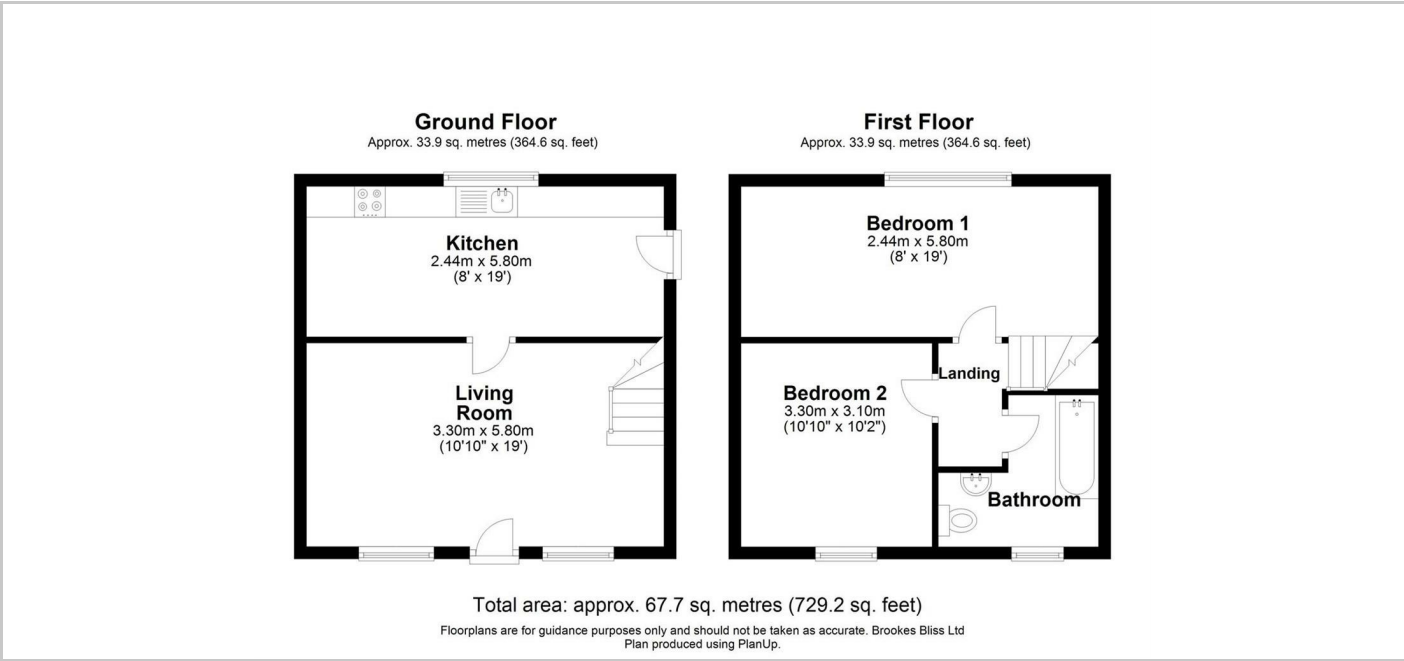

FEES

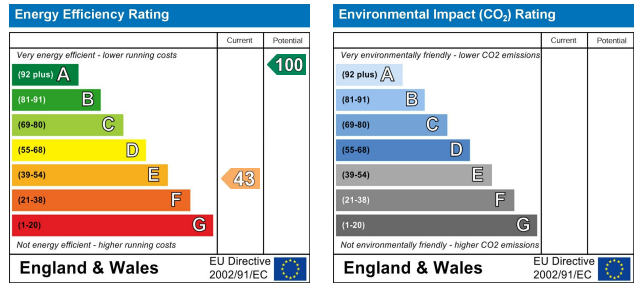

Brookes Bliss

These particulars are offered on the understanding that all negotiations are conducted through this company. Neither these particulars, nor oral representations, form part of any offer or contract, and their accuracy cannot be guaranteed.

46 Bridge Street, Hereford, Herefordshire HR4 9DG  
Tel: 01432 343800  
Lettings@brookes.bliss.co.uk

brookesbliss.co.uk

